

**Model** **Specifications**

**SR20B1G0**

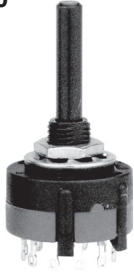

DIRECTION OF ROTATION

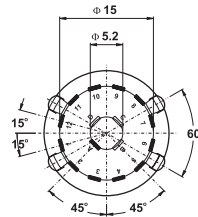
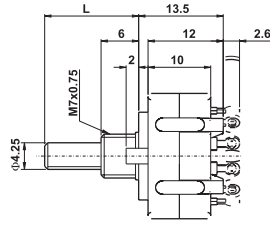
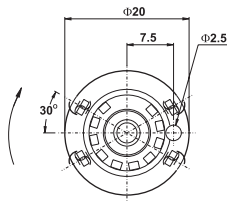

CHANGEOVER ANGLE=30°  
Timing: ① Shorting(make before break)  
② Non-Shorting(break before make)

**WIRING TYPE**

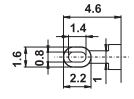

**R-TYPE**

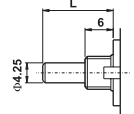

A:7.0mm(standard)

15R	20R	25R	
L	15	20	25

**SR20B1V0**

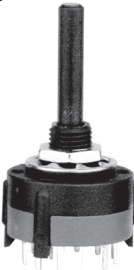

DIRECTION OF ROTATION

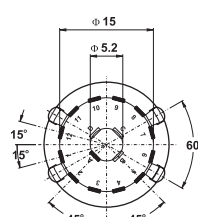
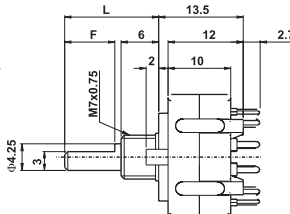
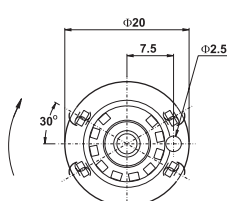

CHANGEOVER ANGLE=30°  
Timing: ① Shorting(make before break)  
② Non-Shorting(break before make)

**P.C.B TYPE**



**D-TYPE**

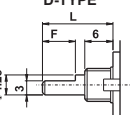

A:7.0mm(standard)

15D	20D	25D	
F	9	14	19
L	15	20	25

**SR20F1G0**



DIRECTION OF ROTATION

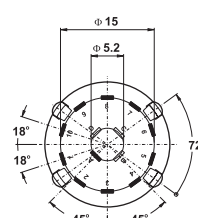
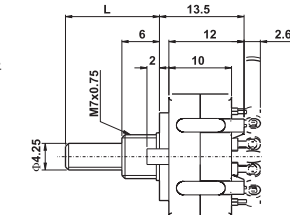
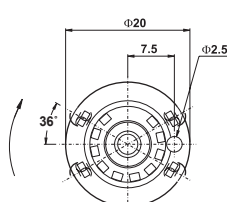

CHANGEOVER ANGLE=36°  
Timing: ① Shorting(make before break)  
② Non-Shorting(break before make)

**WIRING TYPE**

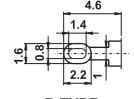

**R-TYPE**

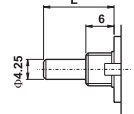

A:7.0mm(standard)

15R	20R	25R	
L	15	20	25

**SR20F1V0**



DIRECTION OF ROTATION

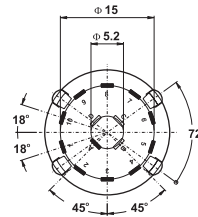
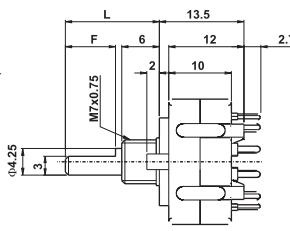
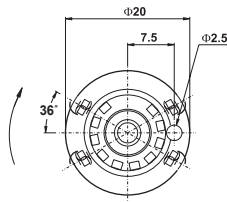

CHANGEOVER ANGLE=36°  
Timing: ① Shorting(make before break)  
② Non-Shorting(break before make)

**P.C.B TYPE**

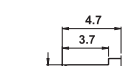

**D-TYPE**

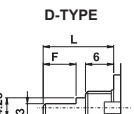

A:7.0mm(standard)

15D	20D	25D	
F	9	14	19
L	15	20	25

SW.FUNCTION: SR20B1			SW.FUNCTION: SR20F1			SPECIFICATIONS	
SP 2 POS.	DP 2 POS.	SP 2 POS.	DP 2 POS.	SP 2 POS.	RATING:	AC 125V 0.3A	
SP 3 POS.	DP 3 POS.	SP 3 POS.	DP 3 POS.	SP 3 POS.	CONTACT	RESISTANCE: 25mΩ Max	
SP 4 POS.	DP 4 POS.	SP 4 POS.	DP 4 POS.	SP 4 POS.	INSULATION	RESISTANCE: DC 500V 100mΩ Min	
SP 5 POS.	DP 5 POS.	SP 5 POS.	DP 5 POS.	SP 5 POS.	WITHSTAND	VOLTAGE: AV500V 1Minute	
SP 6 POS.	DP 6 POS.	SP 6 POS.	DP 6 POS.	SP 6 POS.	ROTATION	TORQUE: 0.4 ± 0.2kg/cm	
SP 7 POS.	3P 2 POS.	SP 7 POS.	3P 2 POS.	SP 7 POS.			
SP 8 POS.	3P 3 POS.	SP 8 POS.	3P 3 POS.	SP 8 POS.			
SP 9 POS.	3P 4 POS.	SP 9 POS.	3P 4 POS.	SP 9 POS.			
SP 10 POS.	4P 2 POS.	SP 10 POS.	4P 2 POS.	SP 10 POS.			
SP 11 POS.	4P 3 POS.	DP 2 POS.	4P 3 POS.	DP 2 POS.			
SP 12 POS.		DP 3 POS.		DP 3 POS.			
		DP 4 POS.		DP 4 POS.			
		DP 5 POS.		DP 5 POS.			

Switch